



# Installation and operating instructions

## Pedals

Thank you for purchasing a MERIDA component.

### About these instructions

Carefully read and follow these installation and operating instructions before use. Keep these instructions for future reference.

	<b>Danger</b> Indicates essential safety instructions.
--	---

These instructions are valid for all MERIDA pedals (Fig. an example):

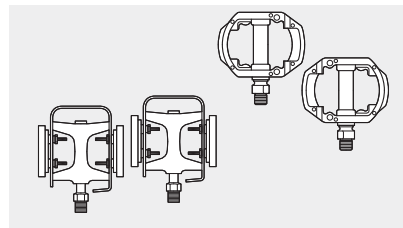

### Special features

As will all lightweight components, special care and attention are required. The material is very durable and has a low weight. However, the material is also very brittle. Therefore, have your bicycle inspected by your dealer following accidents or other incidents.

### Intended use

MERIDA pedals are designed for use with mountain bikes, road bikes, city bikes, and trekking bikes, and their typical use.

### Note before your first ride

	<b>Danger</b> Non-observance of these instructions may lead to the failure of the pedals and result in a serious accident.
	<b>Danger</b> For your own safety, replace the pedals after a heavy impact.
	<b>Danger</b> If you notice external damage, have the pedals checked by your MERIDA dealer.

Do not file or drill and holes in the components as this damages their structure and voids the warranty.

The grip on the pedals decreases in wet and dirty conditions. Ride carefully according to the weather conditions.

## Assembly

	<b>Note</b> Pay attention to the marking on the pedal/packaging: L = left pedal & R = right pedal
--	---

Ensure that the pedals' thread matches the crank before mounting the pedals. Older bicycles and BMX bikes do not have the usual standard thread. In case of doubt, ask your bicycle dealer.

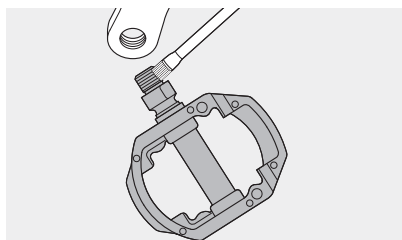

Apply assembly paste to the crank arm threads, and the threads and contact surfaces of the pedal axles.

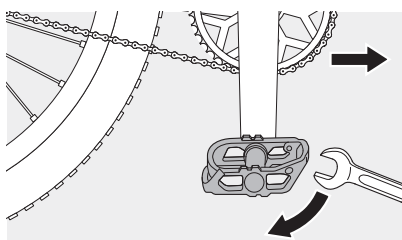

Insert the axle of the right pedal by hand and turn it clockwise slightly. Then tighten it with a pedal wrench or a long 15 mm open-jaw wrench.

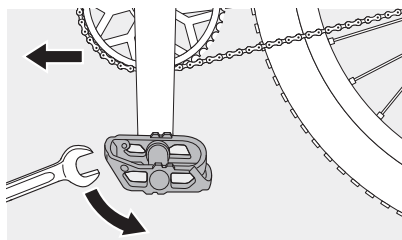

The left pedal has a left-hand thread. Screw in the axle counter-clockwise and then tighten it with a pedal wrench.

	<b>Danger</b> Never exceed the specified torque! Check the torque value after the first 200–400 km (120–240 miles), and then again every 2,000 km (1,200 miles).
--	---

Recommended torque: 30–35 Nm (unless otherwise specified on the pedal).

### Care and maintenance

The pedals' bearings are lubricated and require very little maintenance. Do not clean the pedals with a strong water jet. Regularly check if the pedals exhibit play in their bearings or are difficult to turn. In this case, contact your MERIDA dealer.

## Warranty and guarantee

Statutory warranty rights apply within the first two years. This regulation only applies in states that have ratified the EU bill.

Bar tape and grips are subject to natural wear, depending on use and external conditions.

We also grant a manufacturer's guarantee on all MERIDA components, except grips and bar tape, (from the date of purchase, to the first purchaser) of 5 years on material and workmanship.

Should any defects occurs, contact your MERIDA dealer. In a guarantee case where the respective higher-quality model is unavailable, MERIDA INDUSTRY CO., LTD. reserves the right to deliver the respective current successor model in the available color.

Assembly and/or conversion costs and any accessories will not be refunded in a guarantee case.

The manufacturer guarantee is only valid for the first purchaser upon presentation of proof of purchase with the purchase date, dealer address, and model name.

The intended use is a prerequisite for the guarantee. The guarantee does not cover labor and transportation costs, or any follow-up costs caused by defects.

Competition use in the context of road races, triathlon, or the MTB sections of cross-country races are covered by the guarantee.

Other visible fall damage resulting from jumps or other types of overstress is likewise not covered by the guarantee. The guarantee does not cover damage caused by wear, neglect, crashes, overstressing caused by overloading, improper installation and care, or the modification of components.

In the interest of a long life and durability of the components, the manufacturer's installation instructions and the prescribed maintenance intervals must be adhered to exactly. Failure to comply with the installation instructions and inspection intervals will void the guarantee.

Printing errors in the MCG catalog are reserved. Always check the dimensions of components before installation.

If you have any questions, please contact:

**MERIDA INDUSTRY CO., LTD.**

**P.O. Box 56**

**Yuanlin Taiwan R.O.C.**

**Phone: +886-4-8526171**

**Fax: +886-4-8527881**

**www.merida-bikes.com**

**5th Edition, February 2017**

© No part of this document may be reprinted, translated, reproduced, or otherwise used, e.g. on electronic media without prior written consent.

**Graphics, text, and design**

2W Technische Informations GmbH & Co.KG

www.2wgmh.de